

# AJ-034 AJ-035 Serie

# AJ-036 AJ-037

## Side Entry - SINGLE PORT

### Specifications

#### Material

**Housing:** High Strength Thermoplastic Polyester  
**Contacts:** Phosphor Bronze  
**Contact Plating:** Gold Over Nickel On Mating Area, Tin-lead Alloy On Tails  
**Shield:** Copper Alloy, Tin Plated

#### Electrical

**UL & cUL File:** E131820  
**FCC File:** E149026

### Ordering Information

AJ-XXX-X-X

#### NUMBER OF POSITIONS

034 - 4 P (Metal Pegs)    035 - 4 P (Plastic Pegs)  
 036 - 6 P (Metal Pegs)    037 - 6 P (Plastic Pegs)

#### NUMBER OF POSITIONS & CONTACTS

A = 4p4c  
 B = 6p2c, C = 6p4c, D = 6p6c  
 F = 8p8c

#### GOLD PLATING

1 = 15u, 3 = 50u  
 2 = 30u, 4 = 6u

### PCB Layout

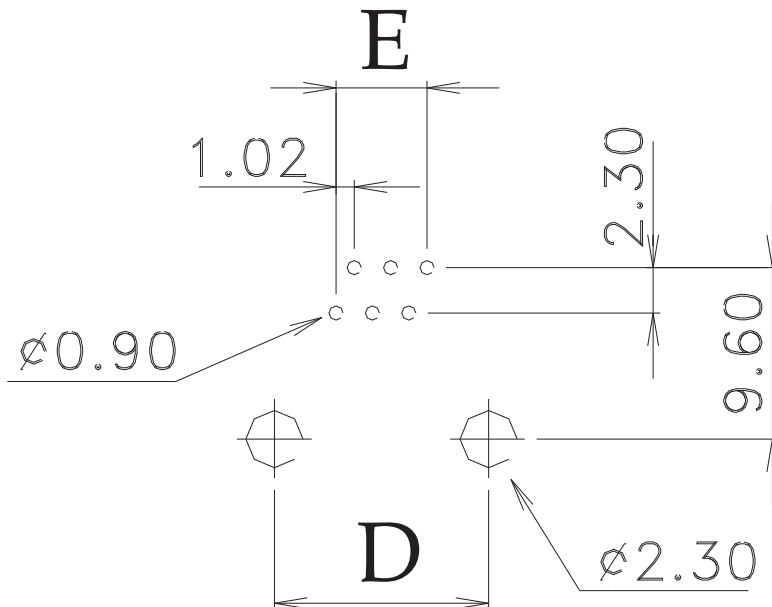

AJ-034 AJ-035 **Serie**  
 AJ-036 AJ-037

*Top Entry - SINGLE PORT*

***Metal Pegs***

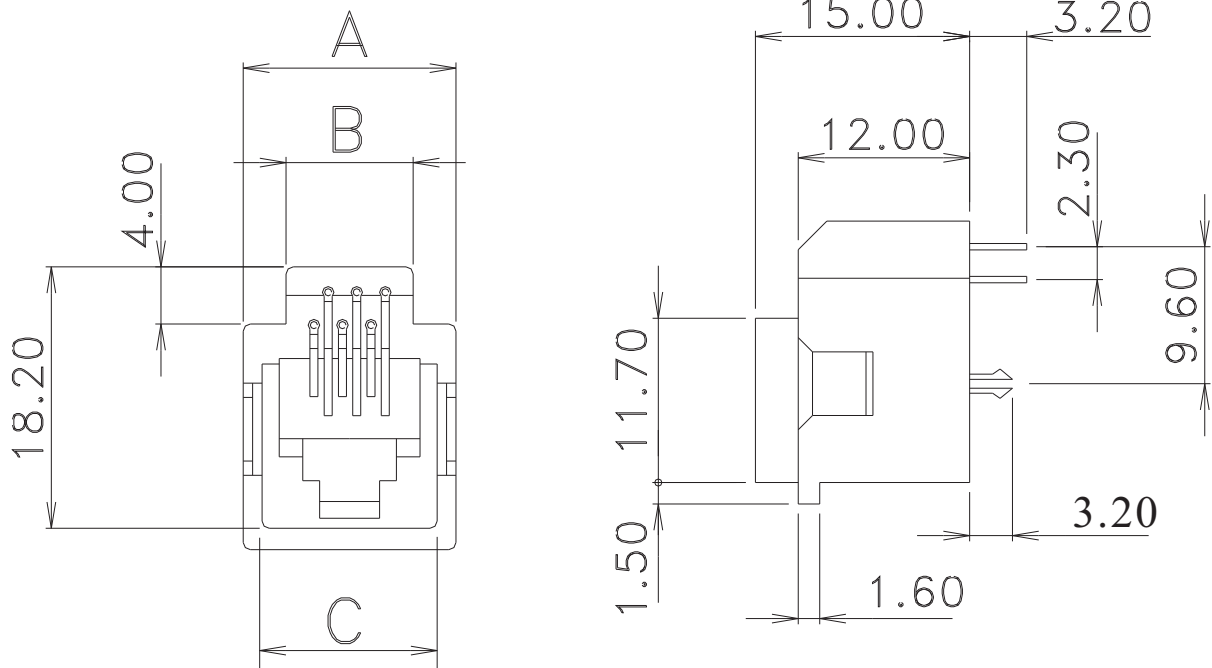

***Platic Pegs***

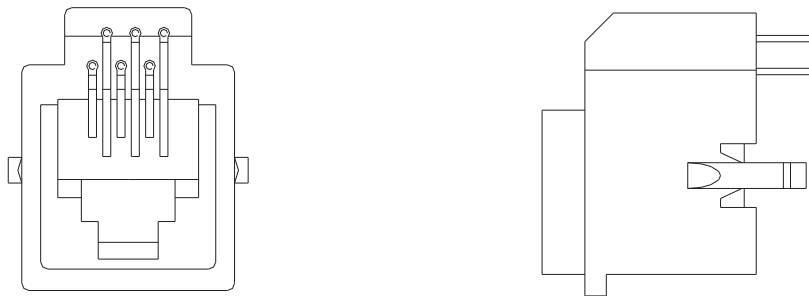

Number Of positions	A	B	C	D	E
4	12.80	6.90	10.30	10.70	3.06
6	14.90	8.90	12.20	12.70	5.10