

AJ-034 AJ-035 AJ-036 AJ-037 *Serie*

Side Entry - SINGLE PORT

Specifications

Material

Housing :	High Strength Thermoplastic Polyester
Contacts :	Phosphor Bronze
Contact Plating :	Gold Over Nickel On Mating Area, Tin-lead Alloy On Tails
Shield :	Copper Alloy, Tin Plated

Electrical

UL & cUL File :	E131820
FCC File :	E149026

Ordering Information

AJ-XXX-X-X

NUMBER OF POSITIONS

034 - 4 P (Metal Pegs) 035 - 4 P (Plastic Pegs)
036 - 6 P (Metal Pegs) 037 - 6 P (Plastic Pegs)

NUMBER OF POSITIONS & CONTACTS

A = 4p4c
B = 6p2c , C = 6p4c , D = 6p6c

GOLD PLATING

1 = 15u , 3 = 50u
2 = 30u , 4 = 6u

PCB Layout

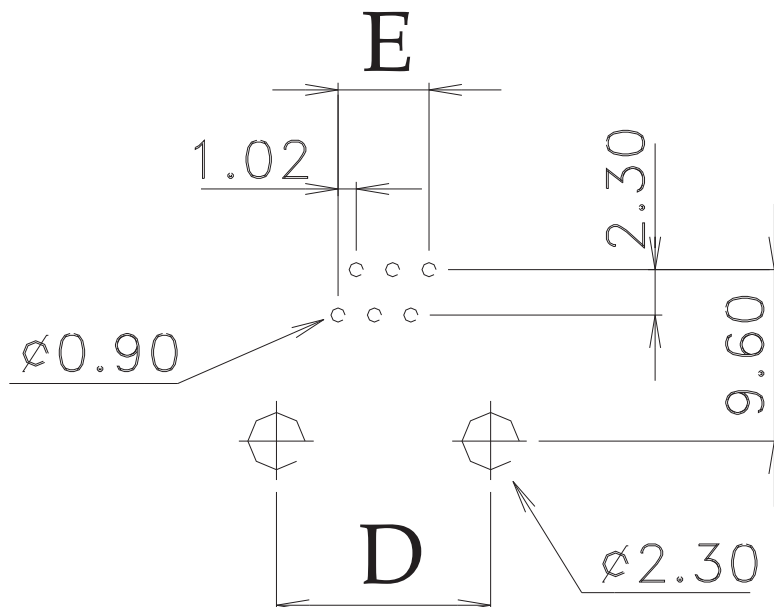

AJ-034 AJ-035 **Serie**
 AJ-036 AJ-037

Top Entry - SINGLE PORT

Metal Pegs

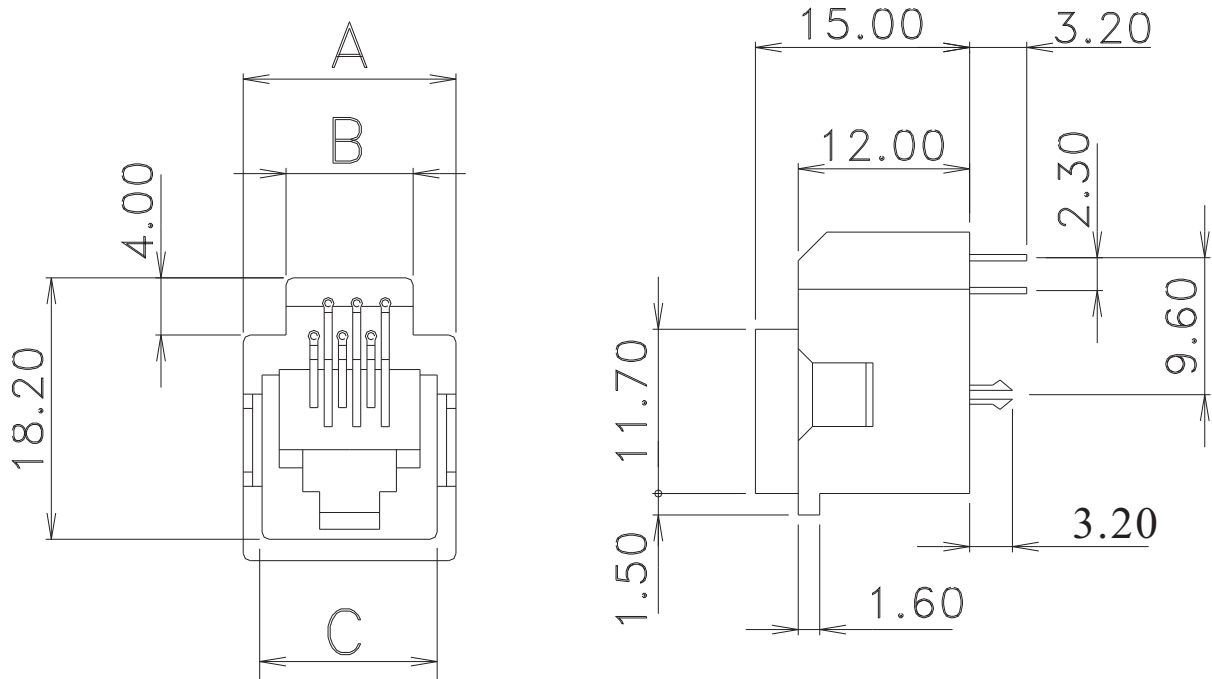

Platic Pegs

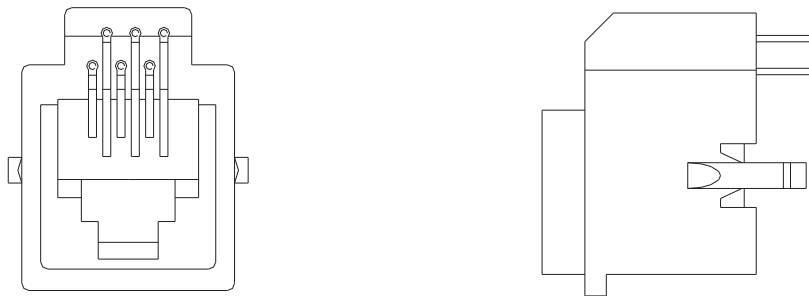

Number Of positions	A	B	C	D	E
4	12.80	6.90	10.30	10.70	3.06
6	14.90	8.90	12.20	12.70	5.10