

# AJ-034 AJ-035 AJ-036 AJ-037 *Serie*

## Side Entry - SINGLE PORT

### Specifications

#### Material

Housing :	High Strength Thermoplastic Polyester
Contacts :	Phosphor Bronze
Contact Plating :	Gold Over Nickel On Mating Area, Tin-lead Alloy On Tails
Shield :	Copper Alloy, Tin Plated

#### Electrical

UL & cUL File :	E131820
FCC File :	E149026

### Ordering Information

AJ-XXX-X-X

#### NUMBER OF POSITIONS

034 - 4 P (Metal Pegs)    035 - 4 P (Plastic Pegs)  
036 - 6 P (Metal Pegs)    037 - 6 P (Plastic Pegs)

#### NUMBER OF POSITIONS & CONTACTS

A = 4p4c  
B = 6p2c , C = 6p4c , D = 6p6c

#### GOLD PLATING

1 = 15u , 3 = 50u  
2 = 30u , 4 = 6u

### PCB Layout

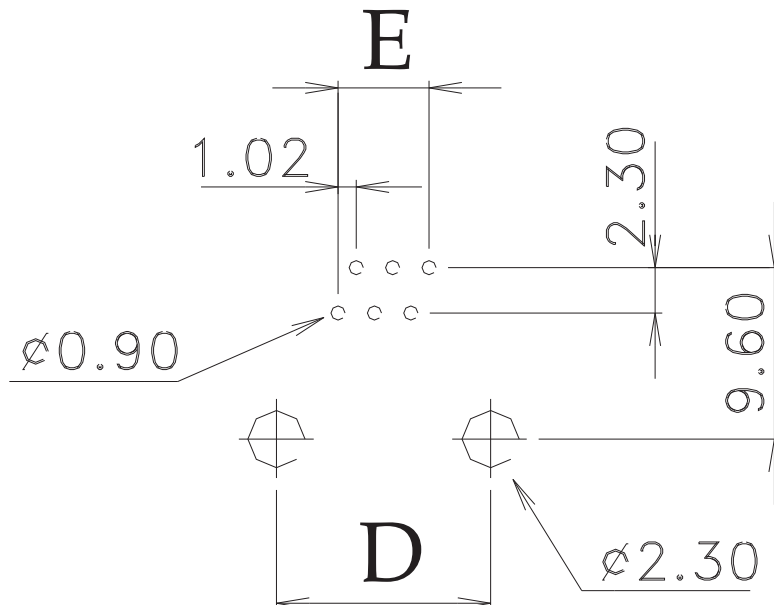

AJ-034 AJ-035 **Serie**  
 AJ-036 AJ-037

Top Entry - SINGLE PORT

**Metal Pegs**

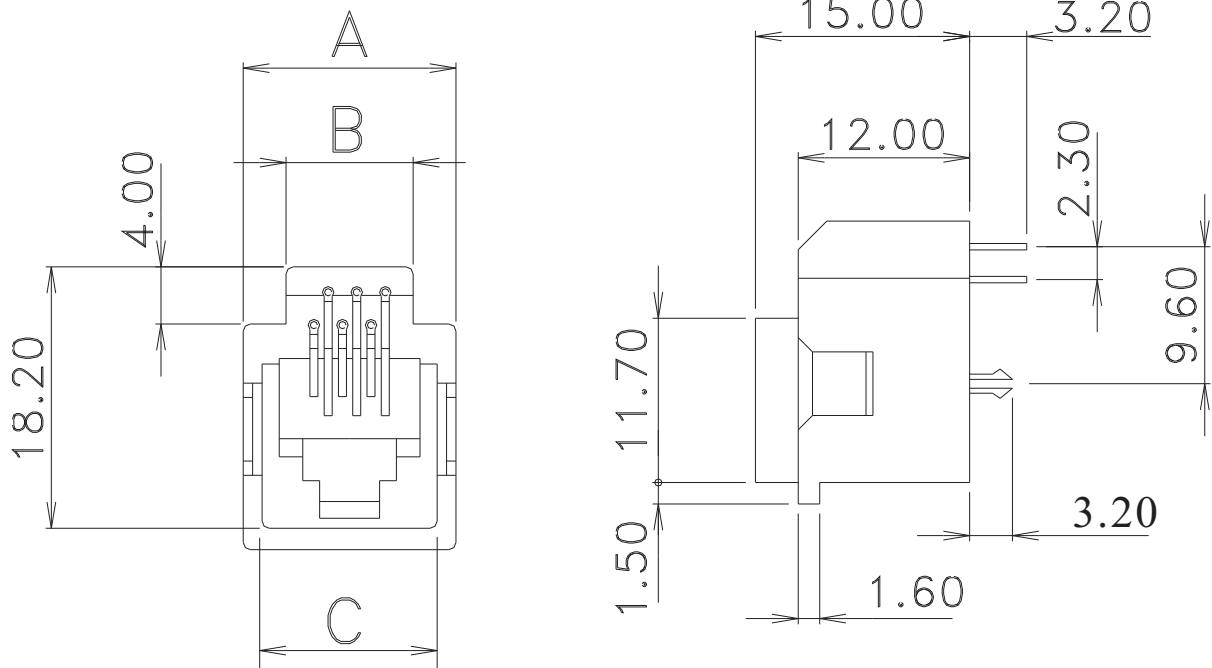

**Platic Pegs**

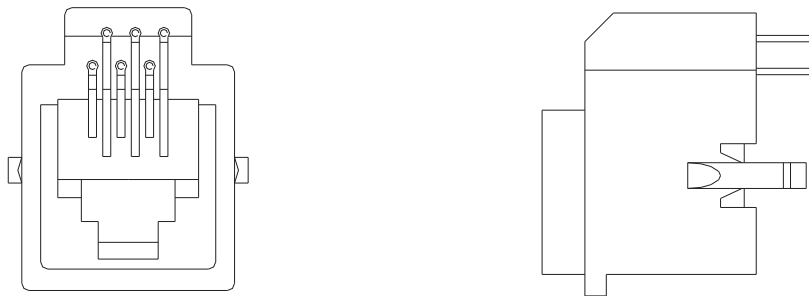

Number Of positions	A	B	C	D	E
4	12.80	6.90	10.30	10.70	3.06
6	14.90	8.90	12.20	12.70	5.10