

AJ-046 AJ-047 Serie

AJ-048 AJ-049 Serie

Side Entry - SINGLE PORT

Specifications

Material

Housing: High Strength Thermoplastic Polyester
Contacts: Phosphor Bronze
Contact Plating: Gold Over Nickel On Mating Area, Tin-lead Alloy On Tails
Shield: Copper Alloy, Tin Plated

Electrical

UL & cUL File: E131820
FCC File: E149026

Ordering Information

AJ-XXX-X-X

NUMBER OF POSITIONS

046 - 6 P (Platic Pegs) 047 - 6 P (Metal Pegs)
 048 - 8 P (Platic Pegs) 049 - 8 P (Metal Pegs)

NUMBER OF POSITIONS & CONTACTS

B = 6p2c, C = 6p4c, D = 6p6c
 F = 8p8c

GOLD PLATING

1 = 15u, 3 = 50u
 2 = 30u, 4 = 6u

PCB Layout

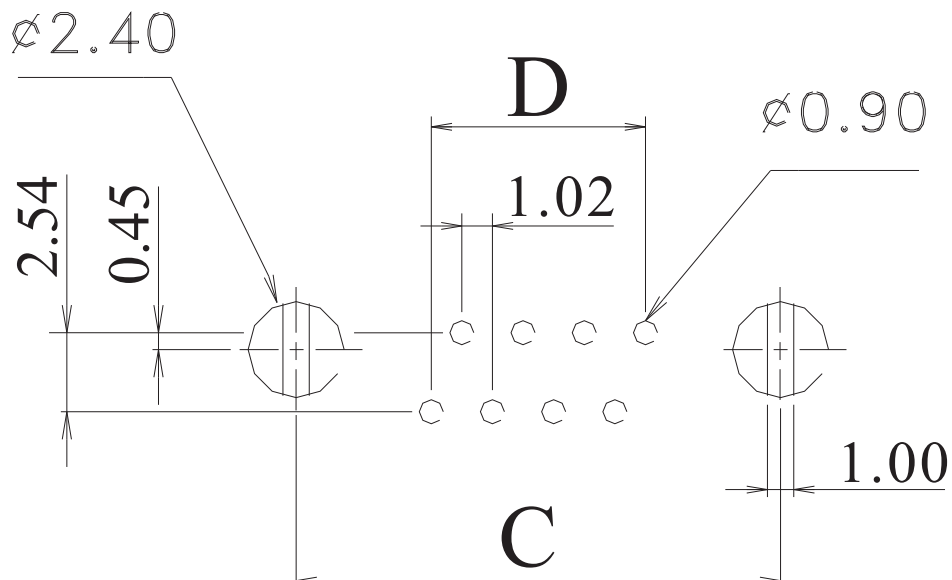

AJ-046 AJ-047 **Serie**
 AJ-048 AJ-049

Side Entry - SINGLE PORT

Platic Pegs

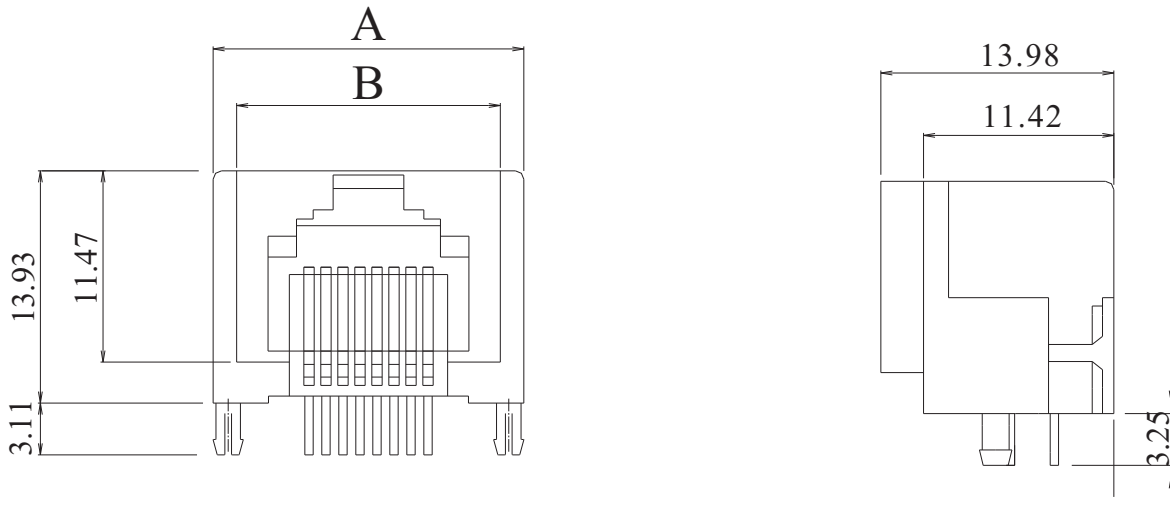

Metal Pegs

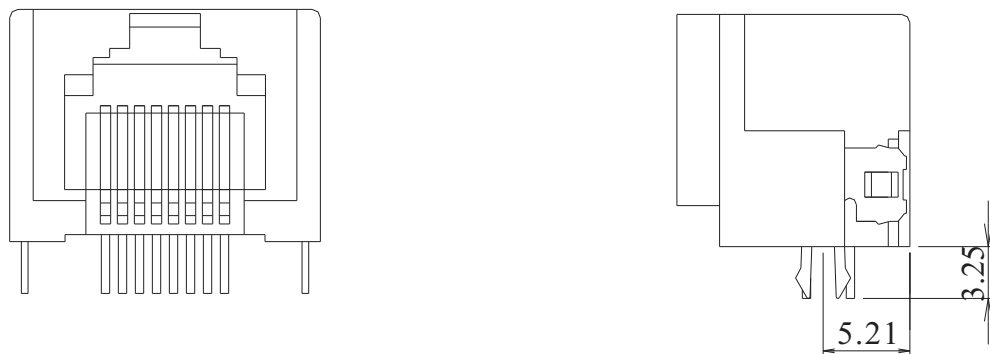

Number Of positions	A	B	C	D
6	14.80	12.20	12.00	5.10
8	18.60	16.00	15.00	7.14